

Rotary couplings for pneumatics

without/with electronical rotary connection, nominal diameter 3, pmax. 10 bar

800-1

Issue: 10/2022

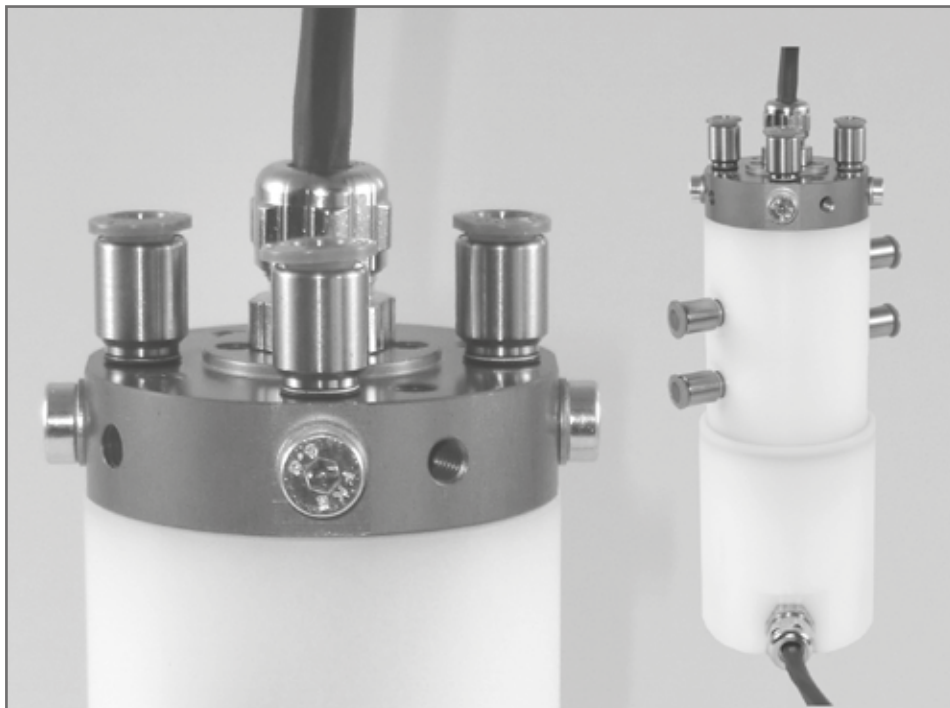

*Application example: four passage rotary coupling with electronical rotary connection.
Special design with housing completely made of durable plastics.*

Description:

Rotary couplings for pneumatics transfer compressed air from a stationary to a rotating machine part. The mounting is made in the rotational axis of the component. For that, we offer versions with single, twin and four passages.

The rotary couplings for pneumatics can be combined with electronical rotary connections by slip rings for 6, 12, 18 or 24 strands at 24 Vdc and 2A.

Installation instructions:

The rotary coupling has to be mounted in a way to not apply bending moment to the stationary or the rotating component.

It has proven effective to screw the (rotating) rotary piston with the connections together with the pneumatic devices and to secure the standing housing only against twisting (do not initiate bearing forces).

Application example:

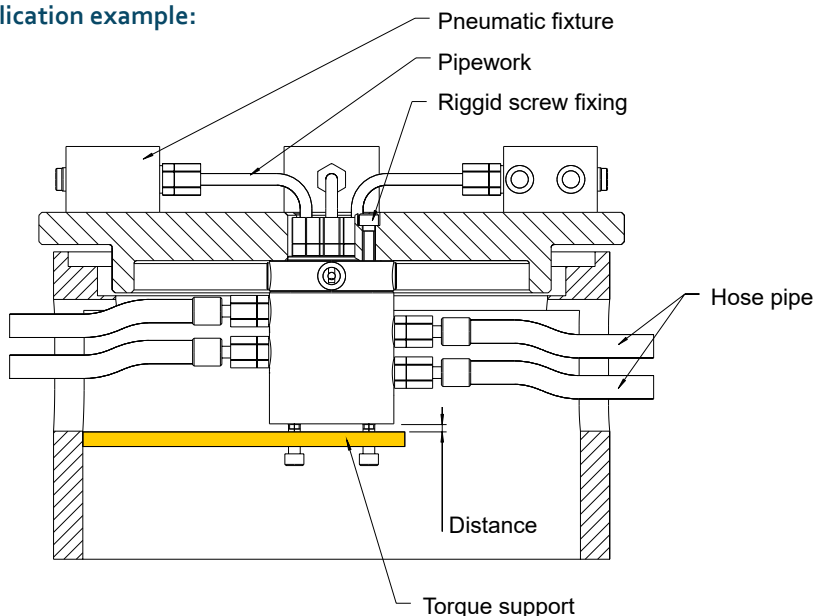

Webcode: 080001

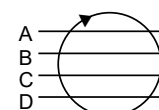

Type of connection:

- ✘ **Threaded port M5**
radial within the housing,
radial or axial within the piston

Operating pressure:

- ✘ **Maximum up to 10 bar**

Operating temperature:

- ✘ **-10°C up to +60°C**

Advantages:

- ✘ **Housing**
made of high-strength aluminium
(Slip ring housing made of durable plastics)
- ✘ **Rotary piston**
made of high-strength aluminium
- ✘ **Light weight**
- ✘ **Rotary connection**
pneumatics and electronics combinable
- ✘ **With ball bearings**

We also design and manufacture customized variants!



HYDROKOMP®

Hydraulische Komponenten GmbH



+49 6401 225999-0



sales@hydrokomp.de



Siemenstr. 16
35325 Mücke (Germany)



www.hydrokomp.de



Single passage

Twin passage

Four passage

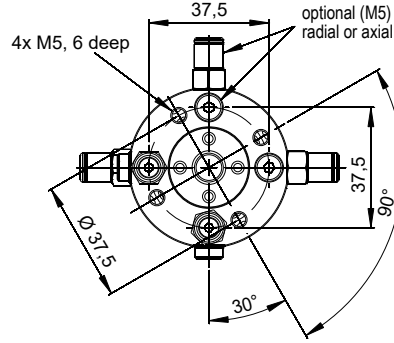
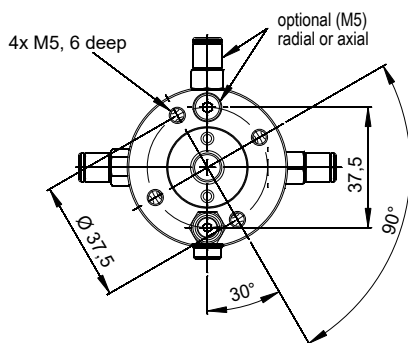
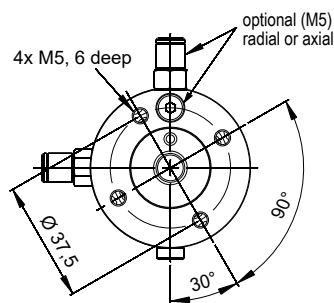
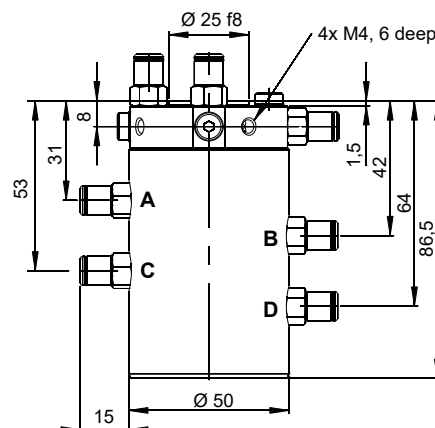
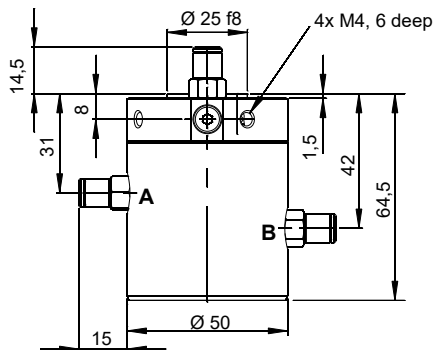
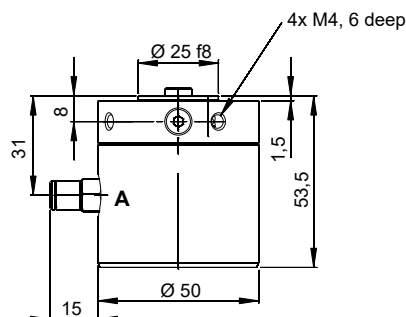
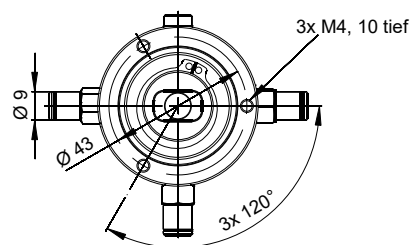
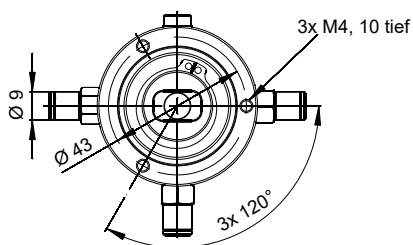
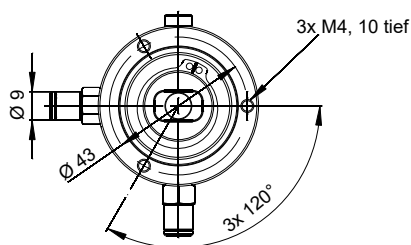
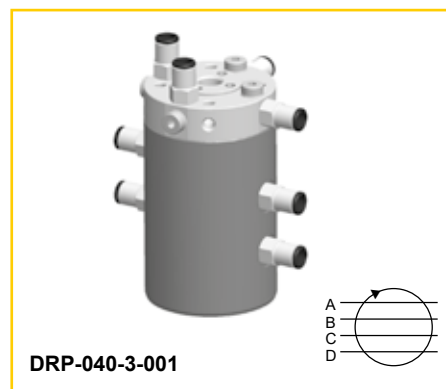
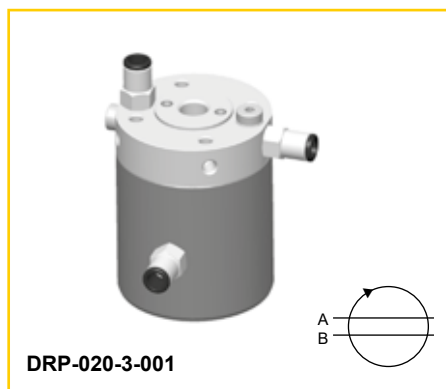
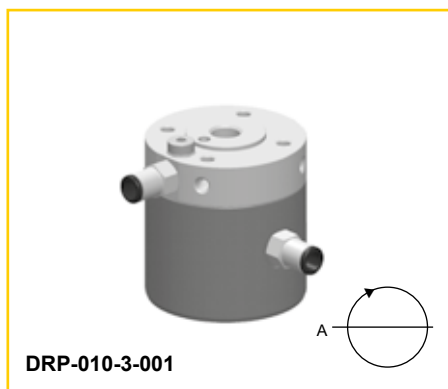

Connections pneumatics	Single passage	Twin passage	Four passage
Nominal diameter	3	3	3
Operating pressure [bar]	0-10	0-10	0-10
Starting torque [Nm]	0,4	0,4	1
Rotational speed, max. [1/min]	60	60	60
Weight approx. [kg]	0,3	0,37	0,49
Order number:	DRP-010-3-001	DRP-020-3-001	DRP-040-3-001



Single passage+elect. rotary connection

Twin passage+elect. rotary connection

Four passage+elect. rotary connection

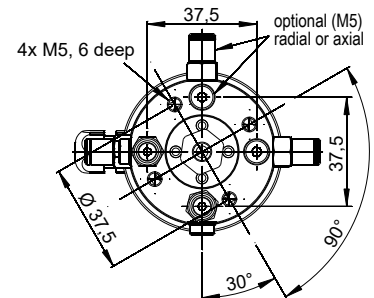
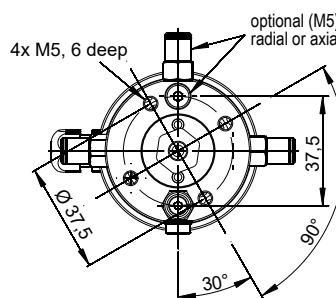
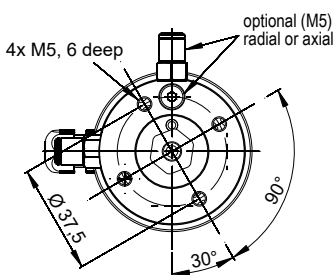
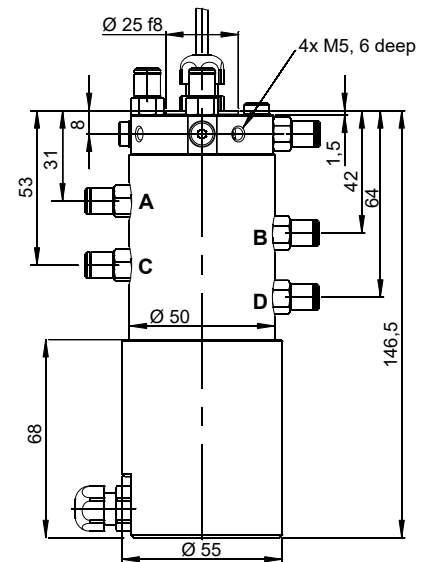
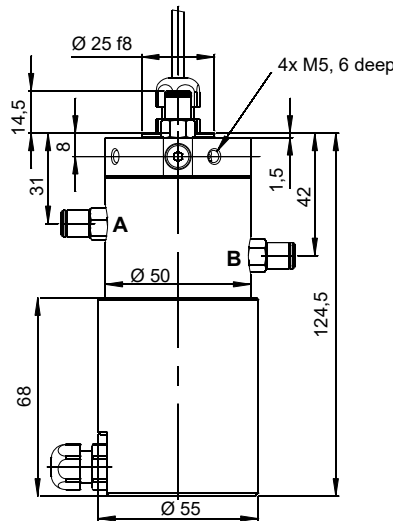
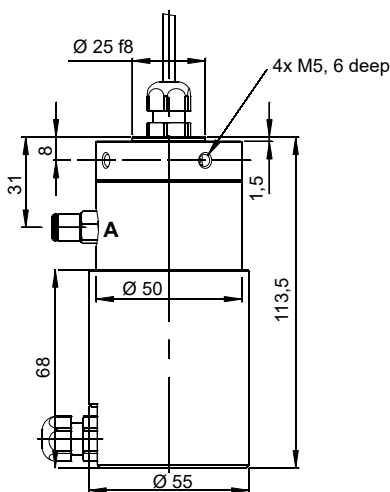
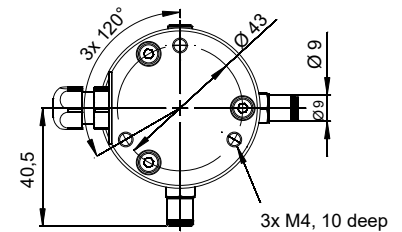
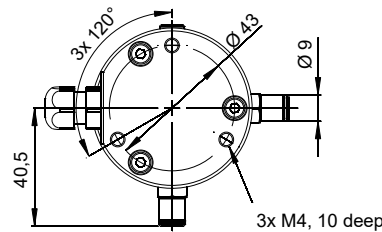
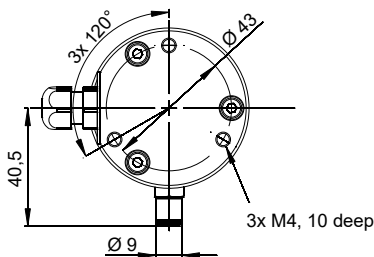
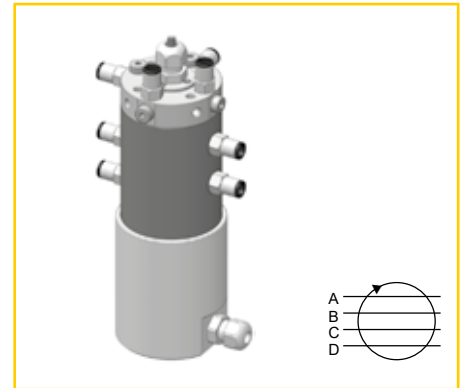
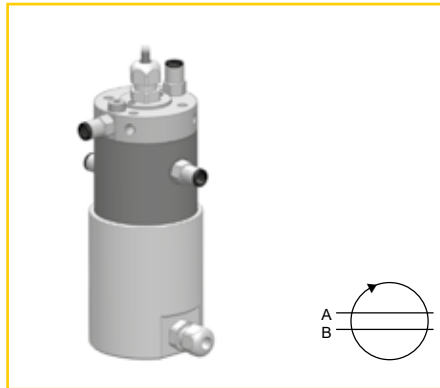
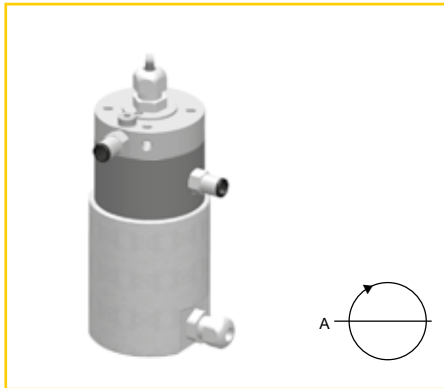

Connections pneumatics	Single passage	Twin passage	Four passage
Electr. connection, each strand	2 A, 24 VDC	2 A, 24 VDC	2 A, 24 VDC
Protection grade	IP 51	IP 51	IP 51
Cable length, each approx. [mm]	300	300	300
Nominal diameter	3	3	3
Operating pressure [bar]	0-10	0-10	0-10
Starting torque [Nm]	0,5	0,7	1,1
Rotational speed, max. [1/min]	60	60	60

Connections electrics	Weight [kg]	Order number:	Weight [kg]	Order number:	Weight [kg]	Order number:
6 Strands	0,54	DRP-010-3-002	0,62	DRP-020-3-002	0,74	DRP-040-3-002
12 Strands	0,58	DRP-010-3-003	0,66	DRP-020-3-003	0,78	DRP-040-3-003
18 Strands	0,53	DRP-010-3-004	0,7	DRP-020-3-004	0,82	DRP-040-3-004
24 Strands	0,66	DRP-010-3-005	0,74	DRP-020-3-005	0,86	DRP-040-3-005